

NELSON STUD WELDING

SPECIFICATION: S2L Setlok Studs

Nelson S2L studs are welded to the structural steel on spacing that matches the pitch of the corrugated sheet metal. The Nelson S2L and Setlok cap system provides a quick, reliable and weatherproof roof or wall construction system. These studs and caps are also used to cover and insulate oil storage tanks.

5/16" impression speed clips, #301001008, are used to retain the insulation until the flat or corrugated covering sheet is applied.

For similar function studs, see Nelson [N3P Navy Type Annular Ring Insulation Pins](#).

When ordering, specify Type, Diameter, Length to Shoulder, Extension Length, Material, Quantity, and Part Number

Example: S2L 5/16 x 1"; 3/8"; Stainless Steel; 5,000 pieces; #101097280

Stud Diameter D	C	B*	Length L	Required Standard Accessories			
				Ferrule	Ferrule Grip	Chuck	Foot
5/16	0.187	0.375	0.687	501101007	501001001	500001006	502001137
5/16	0.187	0.375	0.968	501101007	501001001	500001006	502001137

* B length for 4 laps of 18-gauge material is 0.437"

Length described above is before weld length. The 0.687" length is for all 2-2/3" pitch corrugated steel studs. The 0.968" length is for all 0.032", 2-2/3" pitch corrugated aluminum studs.

MATERIALS: Studs are available in Low Carbon Mills Steel and Stainless Steel. For specific grade information, physical and chemical properties, conforming standards, and information on stud plating, please see [General Material Specifications](#).

Recommended Accessories:

SPECIFICATION: Setlok Caps and Speed Clips

Nelson Setlok Caps are engineered for use in conjunction with Nelson S2L Setlok studs to provide a weatherproof securing option. A rubber-faced hammer is used to impale the sheet metal over the ends of the studs. After the annular rings are exposed, a setting tool and hammer are used to lock the caps onto the studs.

Speed clips, can be used in combination with S2L studs to temporarily retain all types of material that can be readily impaled (fiberglass, foam, felts, and corks, as well as refractory linings and light-density insulation board) until the sheet metal and caps are installed.

When ordering, specify Type, Description, Material, and Quantity

Example: 5/16" Speed Clip; Aluminum; 10,000 pieces; #101301008

Accessory Description	Pin size C	Clip Diameter D	Clip Thickness	Part Number
Setlok Cap	3/16	1/2	0.437	101304001
Setlok Speed Clip	5/16	1-3/8	0.021	101301008
Setlok Setting Tool	--	--	--	505001012

MATERIALS: Studs are available in Low Carbon Mills Steel and Stainless Steel. For specific grade information, physical and chemical properties, conforming standards, and information on stud plating, please see [General Material Specifications](#).

S2L

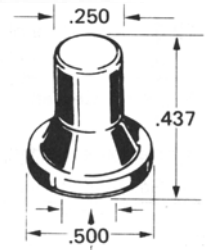
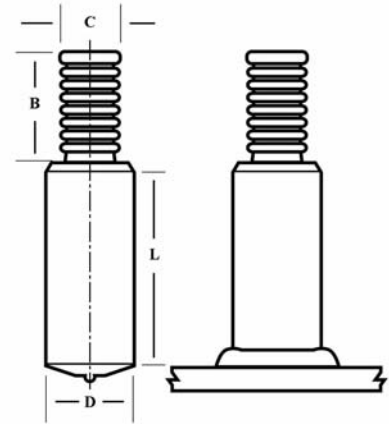

Round Impression Clip

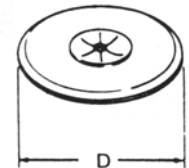

Visit our website www.NelsonStudWelding.com for a list of our standard stock products.